

PROVIDE CARBON MONOXIDE ALARMS OUTSIDE EACH SEPARATE SLEEPING AREA/ BEDROOM WHEN THERE IS AN ATTACHED GARAGE OR ANY FUEL BURNING APPLIANCES IN THE DWELLING AND BE INTERCONNECTED. IRC SECTION: R315

ALL BRANCH CIRCUITS THAT SUPPLY 125-VOLT SINGLE PHASE 15- AND 20-AMPERE RECEPTACLE OUTLETS INSTALLED IN KITCHENS, FAMILY ROOMS, PARLORES, LIBRARIES, DEN'S, BEDROOMS, SUNROOMS, RECREATION ROOMS, CLOSETS, HALLWAYS, LAUNDRY AREAS AND SIMILAR ROOMS OR AREAS SHALL BE PROTECTED BY AN ARC-FULT CIRCUIT INTERRUPTER(S). IRC SECTION: E3902.16, NEC: 310-12B

SERIES RATED

PANEL BOARD NO. 'A'		VOLTAGE 240/120V, 1Ø 3W	
MOUNTING SURFACE		BUS 400A NCB, ALL-IN-ONE	
ENCLOSURE NEMA 3R		CB I.C. 22000/10000	
CIRCUIT DESCRIPTION	WIRE SIZE	NO. CB	CIRCUIT DESCRIPTION
KITCHEN LIGHTS	#12	1	DINING ROOM
GARAGE LIGHTS	#14	3	BATH GFCL
KITCH SMALL APPLIANCE	#12	5	HALLWAY L19/RECEPTS
KITCH SMALL APPLIANCE	#12	5	GARAGE RECEPTS
DISHWASHER/DISPOSAL	#12	1	GARAGE DOOR OPENERS
MICROWAVE	#12	9	GARAGE 240V RECEPTACLE
RANGE/OVEN 5000 KUL	#10	13	CLOTHES WASHER
DUAL FUEL	#10	15	CLOTHES DRYER 3KUL, 240V, 1Ø
REFRIGERATOR	#12	11	COND. UNIT A 5 TON, 240V, 1Ø
FAMILY ROOM RECEPTS	#14	13	SPACE
FAMILY ROOM LIGHTS	#14	13	SPACE
GARAGE GFCL	#12	23	SPACE
AVV EQUIPMENT	#14	25	SPACE
M4S BEDROOM LIGHT / POWER	#14	21	SPACE
M4S BEDROOM LIGHT / POWER	#14	21	SPACE
WATER HEATER 2 TON, 240V, 1Ø	#10	31	SPACE
SPACE	#12	33	SPACE
SPACE	#12	35	SPACE
SPACE	#12	37	SPACE
SPACE	#12	39	SPACE
SPACE	#12	40	SPACE

SERIES RATED

PANEL BOARD NO. 'B'		VOLTAGE 240/120V, 1Ø 3W	
MOUNTING SURFACE		BUS 200A M.L.O.	
ENCLOSURE NEMA 3R		CB I.C. 22000/10000	
CIRCUIT DESCRIPTION	WIRE SIZE	NO. CB	CIRCUIT DESCRIPTION
EXTERIOR LIGHTS	#12	1	COND. UNIT A 5 TON, 240V, 1Ø
EXT GFCL RECEPT.	#12	3	SPACE
KITCH SMALL APPLIANCE	#12	5	SPACE
SPACE	#12	1	SPACE
DISHWASHER/DISPOSAL NO. 2	#12	9	SPACE
MICROWAVE NO. 2	#12	11	SPACE
RANGE/OVEN NO. 2 5000 KUL	#10	13	SPACE
DUAL FUEL	#10	15	SPACE
REFRIGERATOR NO. 2	#12	11	SPACE
COND. UNIT - B 5 - TON	#10	19	SPACE
SPACE	#12	21	SPACE
AIR HANDLER - B 1/2 HP.	#12	23	SPACE
SPACE	#12	25	SPACE
SPACE	#12	27	SPACE
SPACE	#12	29	SPACE
SPACE	#12	31	SPACE
SPACE	#12	33	SPACE
SPACE	#12	35	SPACE
SPACE	#12	37	SPACE
SPACE	#12	39	SPACE
SPACE	#12	40	SPACE

NOTE:
LIGHTEST LINES DENOTE EXISTING CONSTRUCTION

NOTE:
MAIN BONDING JUMPER SHALL NOT BE INSTALLED IN THE SUB-PANEL

NOTE:
200 AMP ELECTRICAL SUB-PANEL

NOTE:
PROVIDE ELECT OUTLET WITH 15' OF AC UNIT PER NEC 100.9

NOTE:
3 TON (1HP-2) SEE M-1 COND UNIT B 60000 BTU'S SEER 14 RHEEM RLU2 MOD. NO. RPH560AJ1 30.4340V/2P/3PHS SURETY SWITCH RATED PER SURETY RECOMMENDATIONS W/ CLEAR UNDER-SIDE PER NEC 100.15

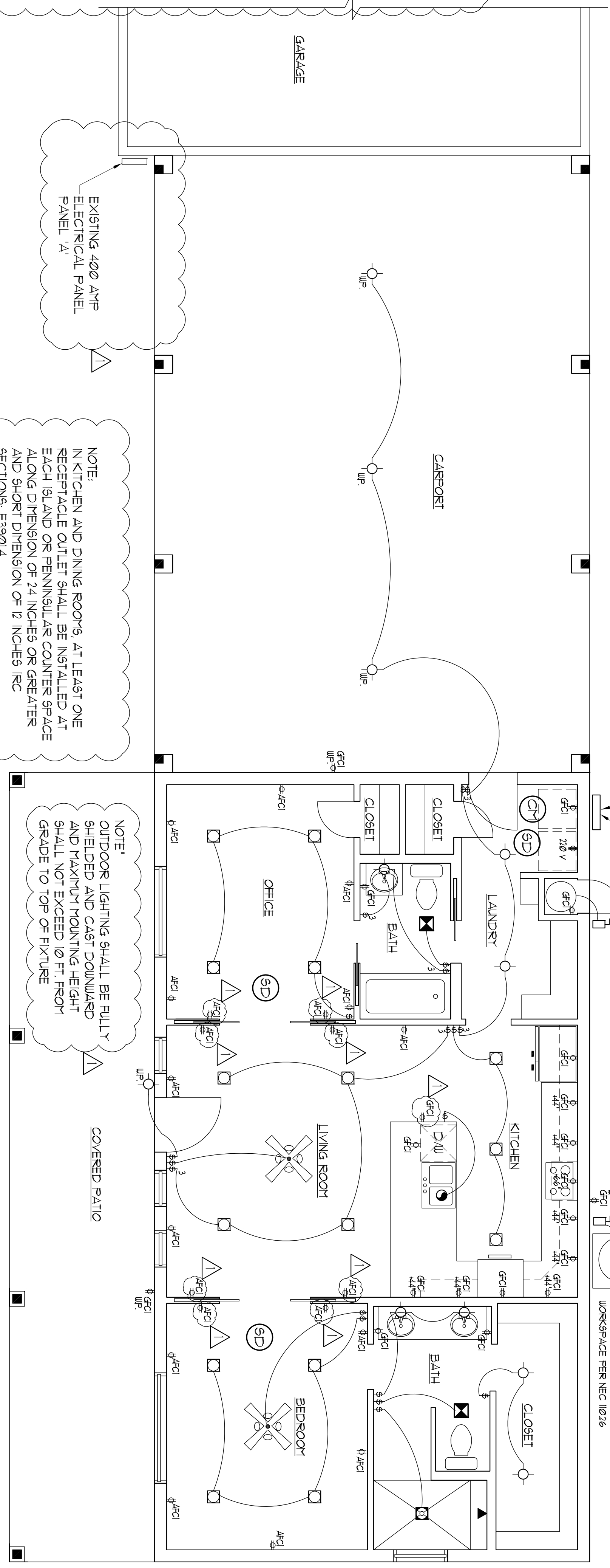

NOTE:
RECEPTACLES SHALL BE INSTALLED SO THAT NO POINT ALONG THE FLOOR LINE IN ANY WALL SPACE IS MORE THAN 6 FEET MEASURED HORIZONTALLY FROM AN OUTLET IN THAT SPACE 2 FEET OR MORE IN WIDTH. IRC SECTION: E3901

NOTE:
WATER HEATER UNIT TO HAVE DISCONNECT PER NEC 440.14 WITH WORKING CLEARANCE PER 6.705 AND 10.26(A) AND OVERCURRENT PROTECTION PER 440.21 AND ARTICLE 240 NEC. NEC SECTIONS: 10.26(A), 440.21, 440.21 ARTICLE 240

ELECTRICAL PLAN - GUEST HOUSE AND CARPORT

1/4" = 1'-0"

FIXTURE LEGEND

- NOTE: EXTERIOR FIXTURES NOT COVERED SHALL HAVE FULL HORIZONTAL OUTLET AND DIRECTED DOWNWARD
- ⊙ CARBON MONOXIDE ALARM 4S PER 2012 IRC 106.11
- ⊙ SMOKE DETECTOR
- ⊙ CEILING FAN LIGHTS
- ⊙ 1ØV ELECTRICAL OUTLET
- ⊙ ARC FAULT CIRCUIT INTERRUPT
- ⊙ GROUND FAULT CIRCUIT INTERRUPT
- ⊙ GROUND FAULT CIRCUIT INTERRUPT - WEATHERPROOF
- ⊙ DISPOSAL
- ⊙ ELECTRICAL PANEL
- ⊙ LIGHT SWITCH
- ⊙ 3 OR 4 WAY SWITCH
- ⊙ LIGHT FIXTURE
- ⊙ PENDANT LIGHT FIXTURE
- ⊙ WEATHER PROOF LIGHT FIXTURE
- ⊙ RECESSED LIGHT FIXTURE TO BE I.C. RATED
- ⊙ RECESSED LIGHTING CANISTER
- ⊙ NOISURE PROOF
- ⊙ EXHAUST FAN

ELECTRICAL LOAD CALCS

DWELLING AREA x 3 WATT PER SQ. FT.	5109 SQ. FT.	15621
LAUNDRY CIRCUIT (2)	2 x 800	3600
KITCHEN SMALL APPLIANCES (3) (4)	4 x 800	7000
FRIDGE (2)	2 x 800	3600
OVEN AT NAME PLATE RATING 2	900	9000
CLOTHES DRYER (2)	2 x 5000	10000
DISHWASHER (2)	2 x 800	3000
WATER HEATER	1 x 4500	4500
DISPOSAL (2)	2 x 800	3000
MICROWAVE (2)	2 x 800	3600
BATH GFCL RECEPTACLES	3 x 800	5400
RANGE GUEST KITCHEN	900	9000
FUTURE POOL		10000
SUB TOTAL		97511
1.1Ø KILOWATTS AT 100%		100000
REMAINER AT 40%		39360
TOTAL LOAD - A/C		26604
(2) 5-TON CONDENSING UNITS AT 1300 WATTS EACH		14600
(1) 3-TON CONDENSING UNITS AT 4380 WATTS EACH		4380
(1) 2-TON CONDENSING UNITS AT 2920 WATTS EACH		2920
(4) 1/2 HP AIR HANDLERS AT 1176 WATTS EACH		4704
TOTAL LOAD		67634
TOTAL AMPS 67634/240 VOLT		282 AMPS

ONE LINE DIAGRAM

