

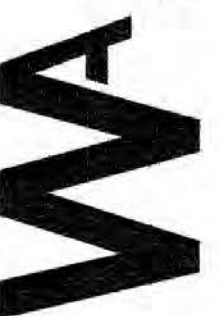

winton architects, inc.
 Phoenix, Az. 85014
 1435 E. Rancho Drive
 (602) 230-9778
 wintonarch@gmail.com



A NEW BUILDING FOR: KIWAMI ON BELL
5327 W. BELL ROAD
GLENDALE, ARIZONA 85306
LOGOS BUILDERS SOUTHWEST

job no. 24114
 drawn MA
 approved AG
 date 7/13/24

revisions

ES2.1

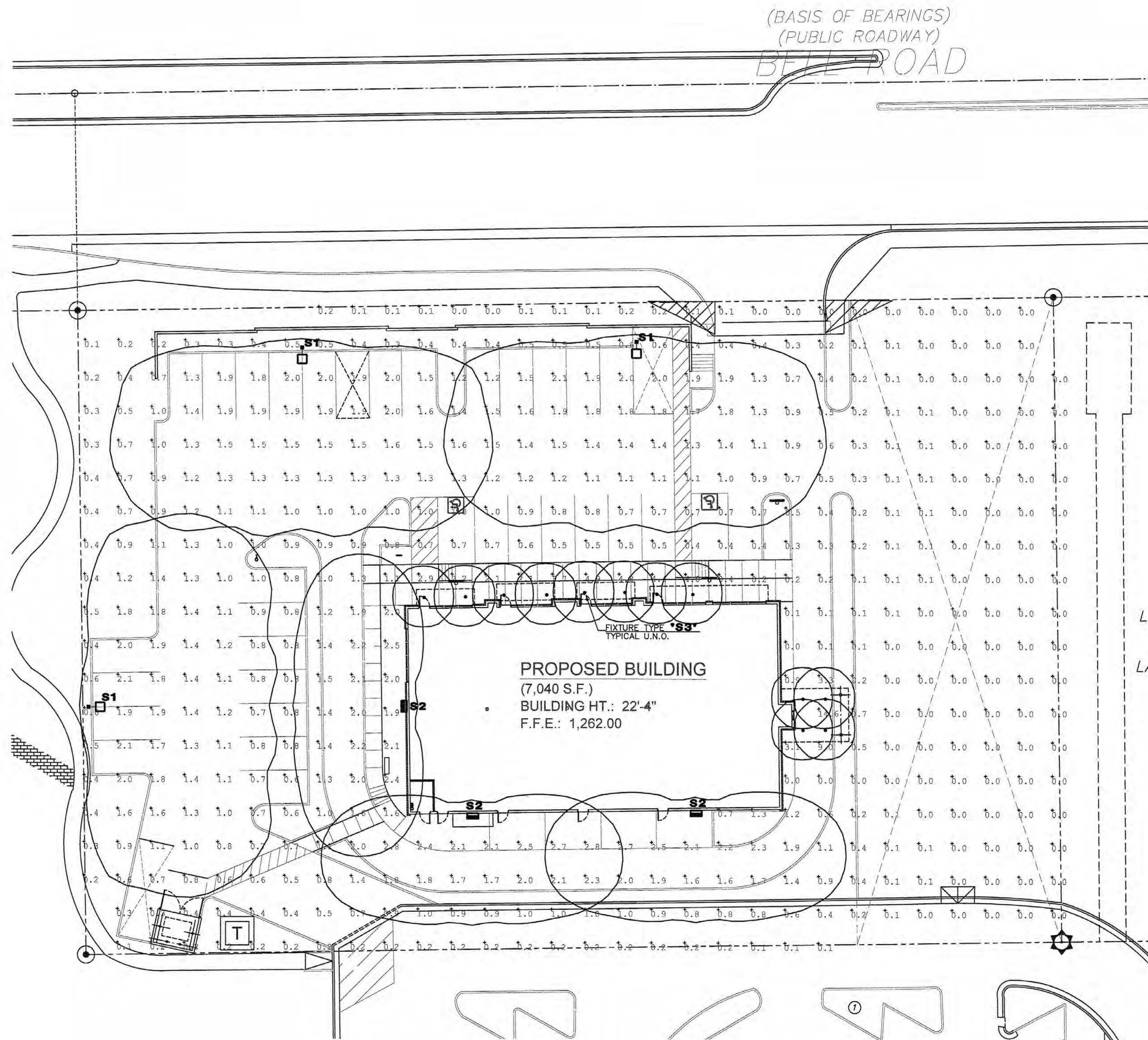

ELECTRICAL POST CURFEW PHOTOMETRIC PLAN
 SCALE: 1" = 20'-0"

Luminaire Schedule										
Qty	Label	Symbol	[MANUFAC]	Description	MH	Lumens	LLF	Watts	Total Watts	BUG Rating
3	S1	☐	BEACON	VP-ST-2-72L-145-4K7-4W-BC	25'	13833	0.650	145	435	B1-U0-G3
3	S2	⊞	HUBBELL OUTDOOR	RWL2-160L-50-4K7-3-U	18'	7839	0.650	54	162	B1-U0-G2
12	S3	⊕	PRESCOLITE	LFR-6RDS-M-15L35K8WD-DM1_LFR-6RDS-T-S	11.5'	1488	0.650	12.273	147.276	B2-U0-G0

Calculation Summary							
Label	CalcType	Units	Avg	Max	Min	Avg/Min	Max/Min
Site Planar	Illuminance	Fc	0.86	14.6	0.0	N.A.	N.A.

NOTE:
 PRE-CURFEW DESIGN HOURS SHALL BE DESIGNED AS DUSK TO 10:00PM
 AND POST-CURFEW DESIGN HOURS SHALL BE DEFINED AS 10:00PM UNTIL
 DAWN. ALL EXTERIOR LIGHTS SHALL BE DIMMED BY NOT LESS THAN 35%
 DURING POST-CURFEW TO COMPLY WITH IECC 2018 C405.2.5. EXTERIOR
 LIGHTING CONTROLS.

DESIGN CODES
 IECC, 2018 NEC, 2017

**ELECTRICAL CONTRACTOR SHALL NOTIFY
 DESIGNER/ENGINEER PRIOR TO ANY DEVIATION
 FROM THIS SET OF ELECTRICAL DESIGN PLANS.
 ANY CHANGES TO THE DESIGN, IF APPROVED
 BY ENGINEER, WILL REQUIRE REVISIONS TO
 PLANS AND POSSIBLE ADDITIONAL SERVICE
 FEE.**

Project Contact/Designer: **MINDY ADLER**
 Project: **424148**
HAWKINS DESIGN GROUP INC.
 ELECTRICAL CONSULTING ENGINEERS
 140 WEST HARWELL ROAD
 GLENDALE, ARIZONA 85306
 PH. 480.813.9000 FAX. 480.813.9001
 EMAIL: email@hawkinsdg.com

All concepts, designs and data indicated on these drawings are the sole property of the Hawkins Design Group Inc. and shall not be used for any other purpose other than originally intended without written permission of the engineer.

IF DRAWING IS NOT PLOTTED AT 24 X 36 THEY ARE NOT FULL SIZE